



SX10/10SR/12/12SR SMALL PARTS KIT

PART NUMBER:

90-42660



**SAVE THESE
INSTRUCTIONS**

CONTENTS

ITEM	QUANTITY	DESCRIPTION
1	1	BRAKE
2	2	DRUM BEARING
3	2	DRUM GASKET
4	2	MOTOR GASKET
5	2	MOTOR O-RING
6	1	GEARBOX GASKET
7	1	BALL BEARING
8	1	GEARBOX BUSHING
9	2	SOCKET SEAL

ANTI-SEIZE LUBRICANT MUST BE USED ON ALL STAINLESS STEEL FASTENERS TO PREVENT THREAD DAMAGE AND GALLING

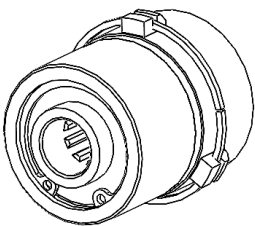
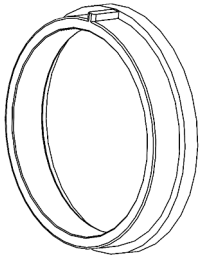
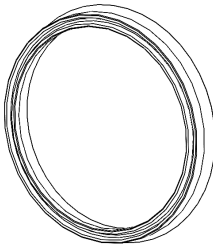
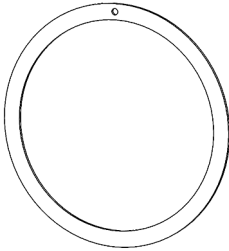
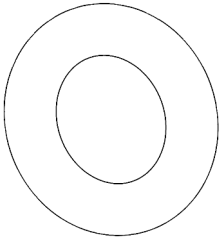
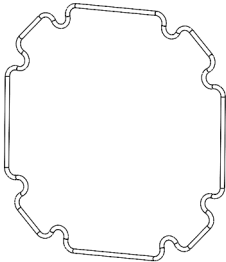
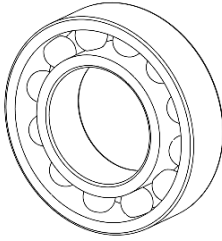
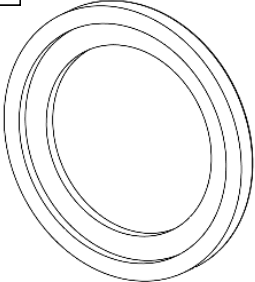
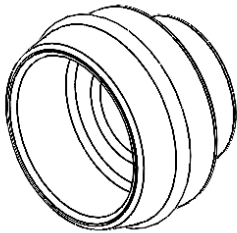
<p>ITEM 1</p> 	<p>ITEM 2</p> 	<p>ITEM 3</p> 	<p>ITEM 4</p> 
<p>ITEM 5</p> 	<p>ITEM 6</p> 	<p>ITEM 7</p> 	<p>ITEM 8</p> 
<p>ITEM 9</p> 			

INSTALLATION INSTRUCTIONS

1. Remove contents from box, verify if all parts listed are present and free from damage. **Failure to identify damage before installation could lead to a rejection of any claim.**
2. Carefully read and understand all instructions before attempting installation. **Ensure that all mounting hardware is torqued to specifications prior to use.**
3. Disconnect the power cable and ground cable from the battery.
4. Remove one M8 serrated flange nut from each motor terminal. See **Figure 1**.
5. Remove the motor cables from the red, yellow, and blue motor terminals. See **Figure 1**.
6. Remove the control box ground cable and battery ground cable from the motor ground terminal. See **Figure 1**.
7. Remove the gearbox assembly from the bar by removing the two socket head bolts holding it in place. See **Figure 2**.
8. Remove the drum and the driveshaft from the winch assembly. See **Figure 3**.

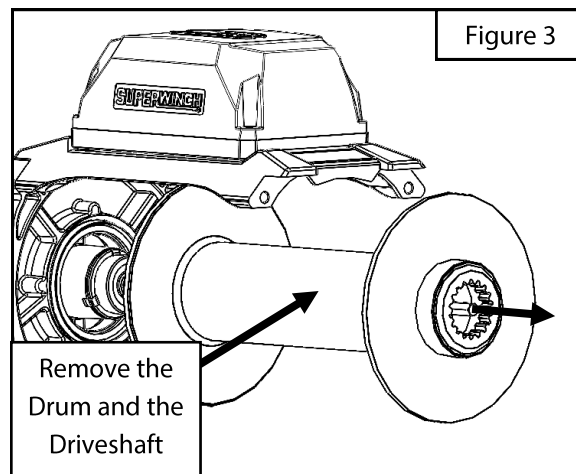
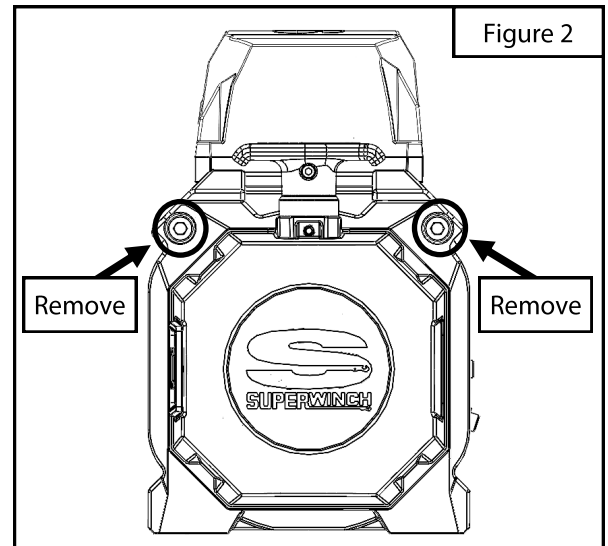
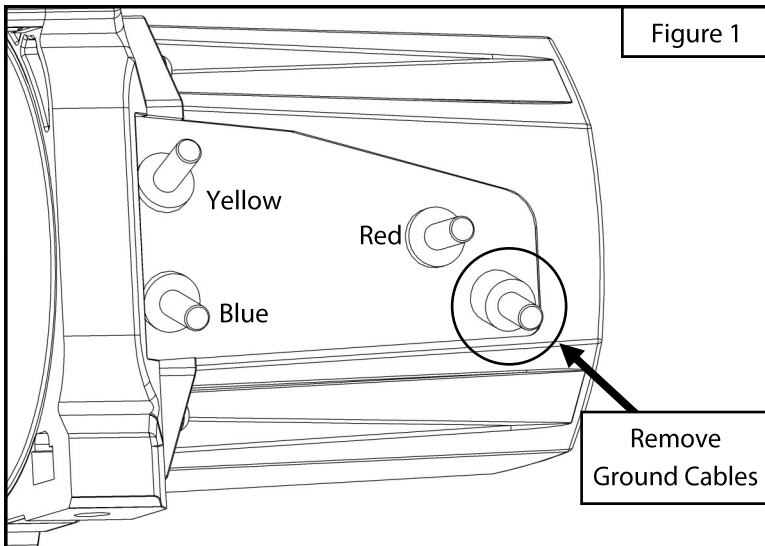

9. Remove the motor assembly from the tie bar by removing the two socket head bolts shown. See **Figure 4**.
10. Remove the original brake from the motor assembly using a snap ring tool to carefully expand and remove the snap ring located in the ring groove shown. See **Figure 5**.
11. Remove and replace the brake (item 1) using the snap ring that was removed in the previous step.
12. Remove and replace the drum bearing (item 2) and drum gasket (item 3) on the motor and gearbox assembly. See **Figures 6 & 7**. **Note:** *It is recommended that you lightly coat the drum bearing and gasket with grease. Make sure that both the drum bearing and gasket are seated completely in their respective locations.*

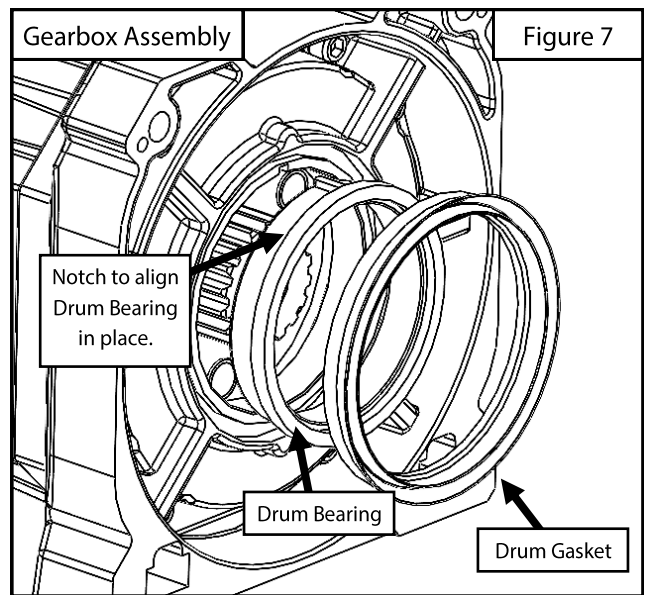
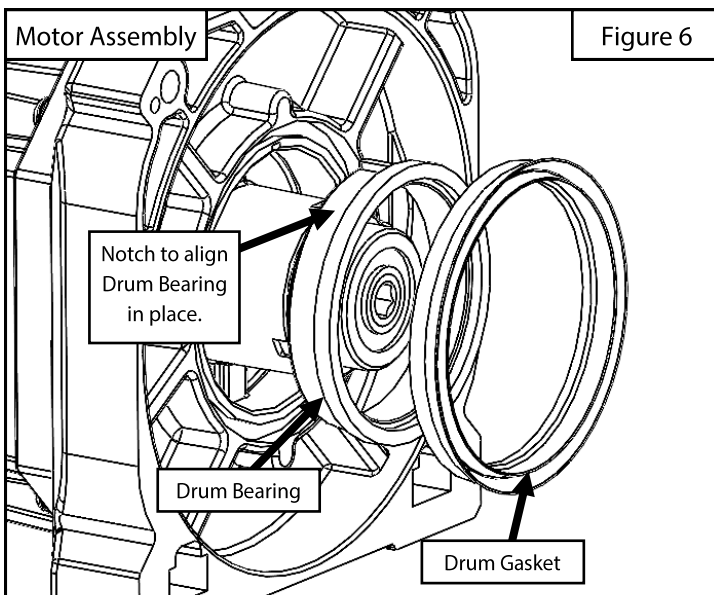
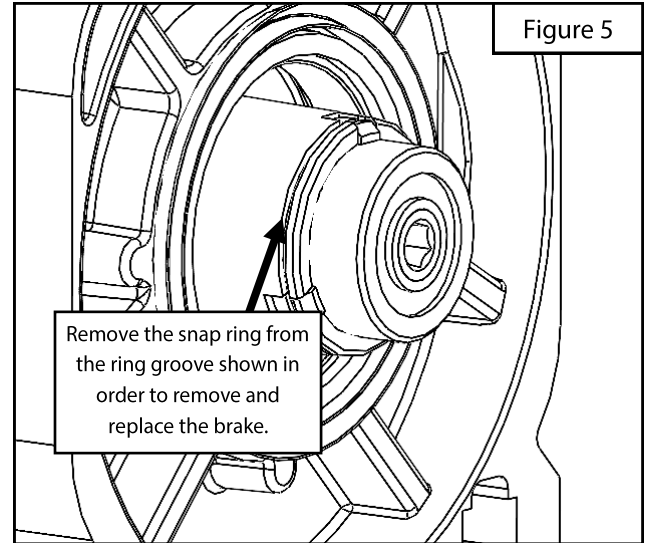
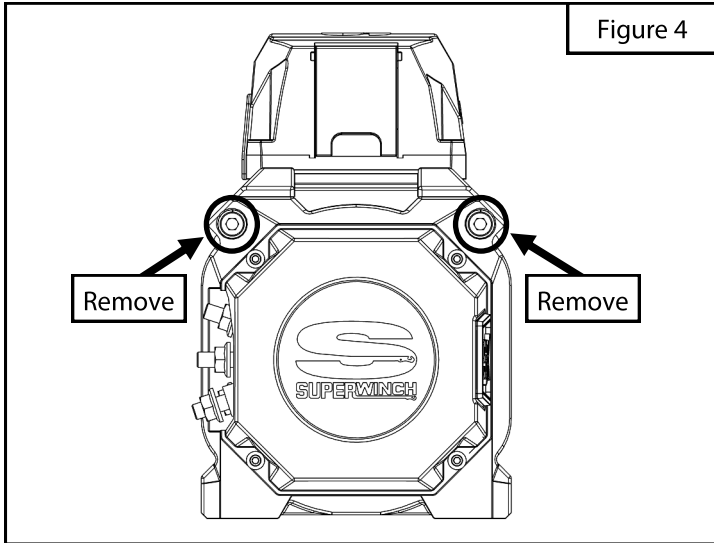

13. Remove the motor cover by removing the four button head bolts holding it in place. See **Figure 8**.
14. Remove motor by removing the two hex head bolts holding it in place. See **Figure 9**.
15. Remove and replace the two motor gaskets (item 4) at either end of the motor. See **Figure 10**. **Note:** *Make sure that the surfaces are free of any debris before replacing the motor gaskets.*
16. Remove and replace the motor O-rings (item 5) on the two bolts that hold the motor in place.
17. Reinstall the motor using the hardware removed in step 14. See **Figure 10**.
18. Reinstall the motor cover by reinstalling the four button head bolts that were previously removed in **step 16**.

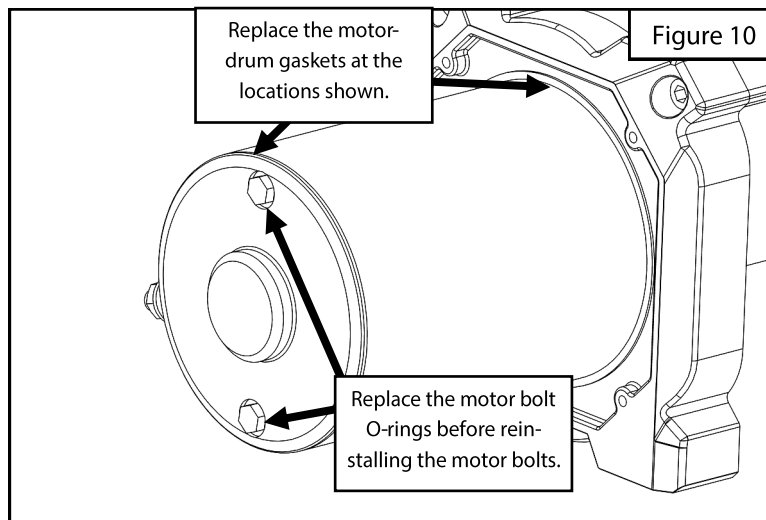
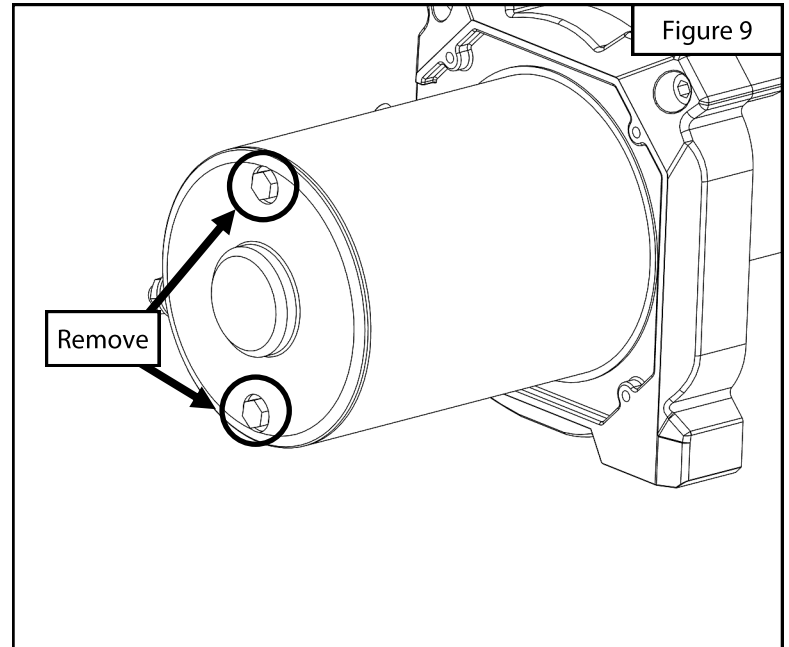
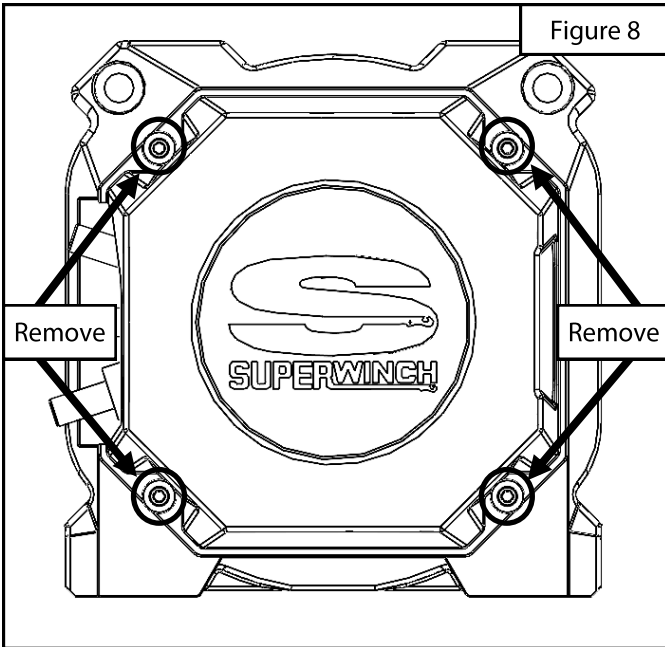

19. Tilt the gearbox assembly upwards and remove the gearbox drum support by removing the eight socket head bolts holding it in place. See **Figure 11**.
20. Remove and replace the gearbox drum gasket (item 6) See **Figure 12**. **Note:** Make sure the replacement gasket is seated into the groove properly.
21. Remove the third stage planetary gearset, gearbox bushing, second stage planetary gearset, and first stage planetary gearset. See **Figure 13**.

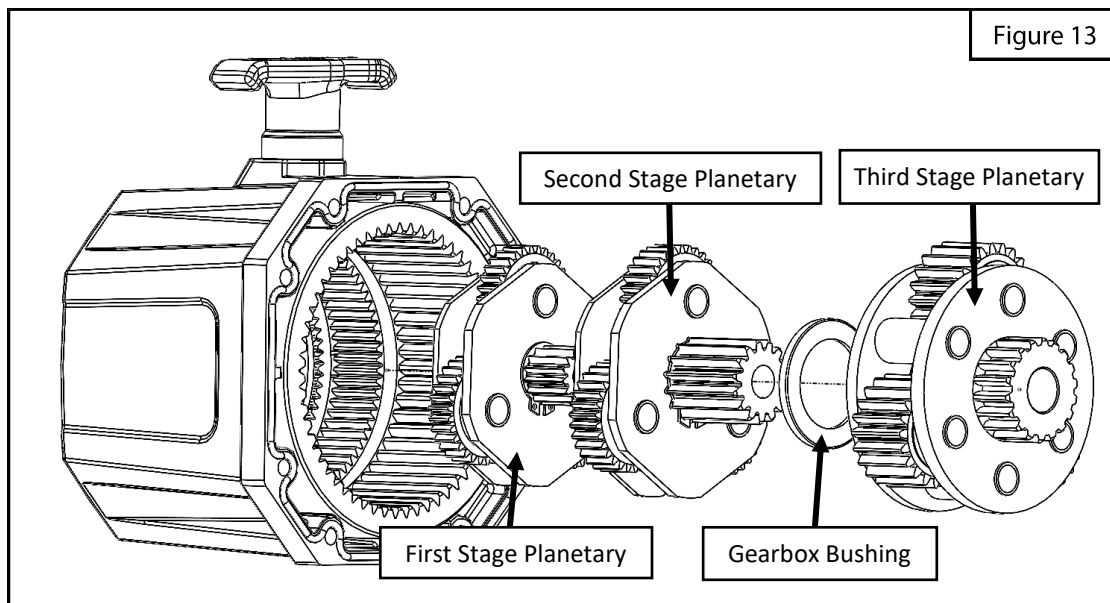
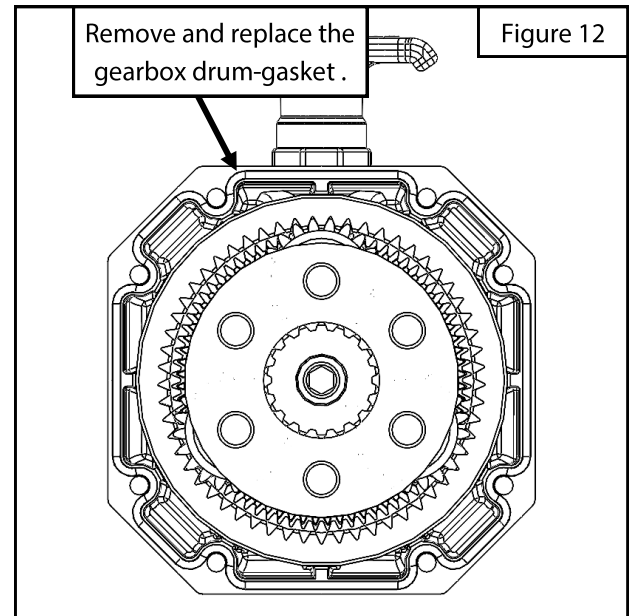
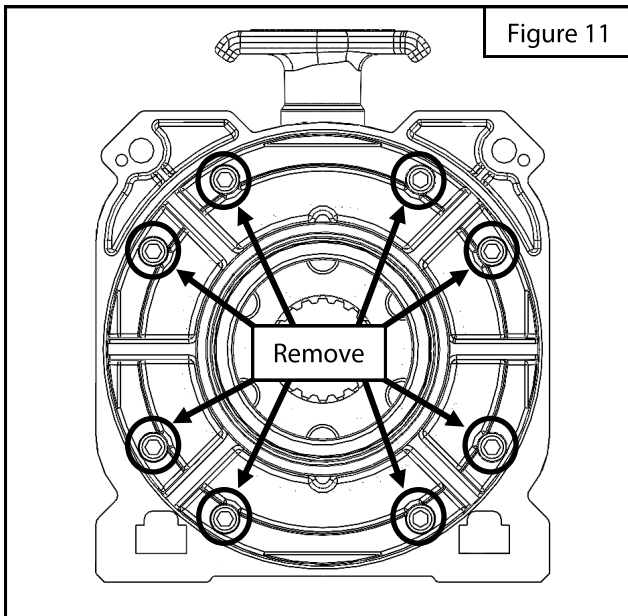

22. Remove the first stage sun gear. See **Figure 14**.

23. Remove and replace the ball bearing (item 7). When installing the replacement, make sure that it is seated completely flush in position relative to the gearbox housing. See **Figure 14**.

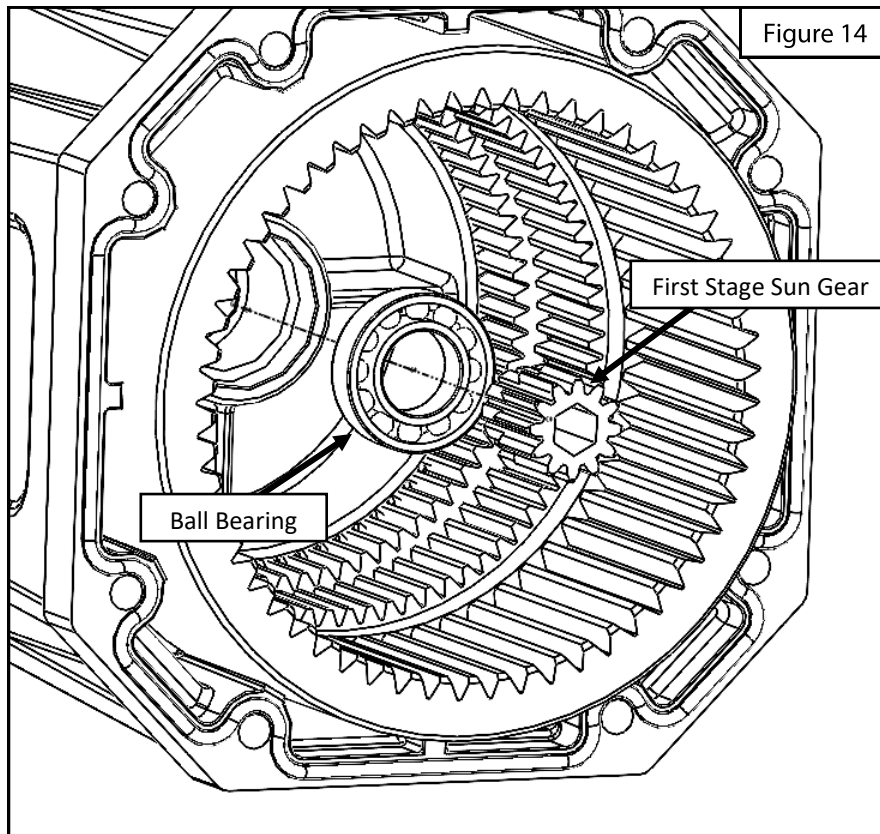

24. Reinstall the first stage sun gear, first stage gearset, and second stage gearset. See **Figure 15**. **Note:** Make sure that the first and second stage gearsets are seated in place.
25. Install the gearbox bushing (item 8) making sure it is seated flush to the second stage planetary gearset. See **Figure 15**.
26. Reinstall the third stage planetary gearset and driveshaft. See **Figure 16**.
27. Rotate the driveshaft in order to ensure that the gear assemblies are installed correctly. See **Figure 16**.

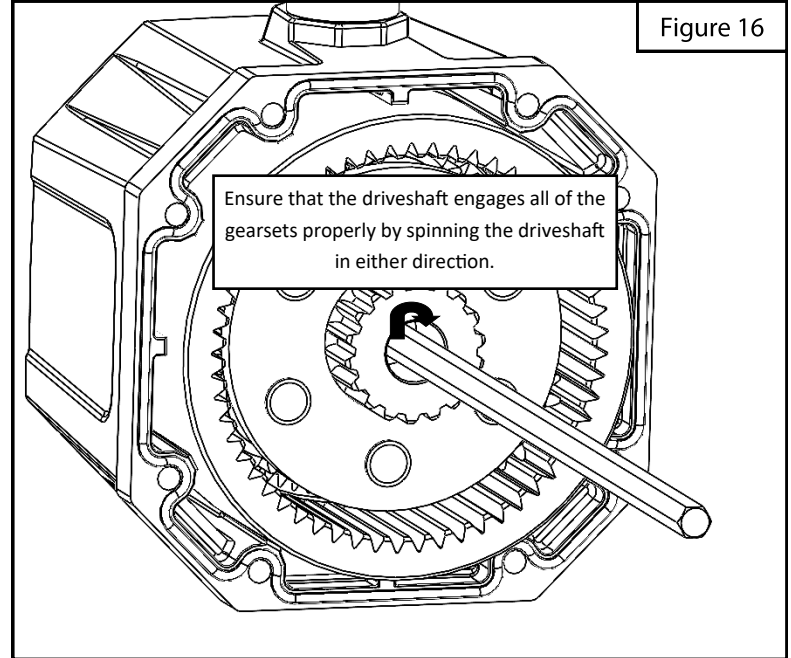
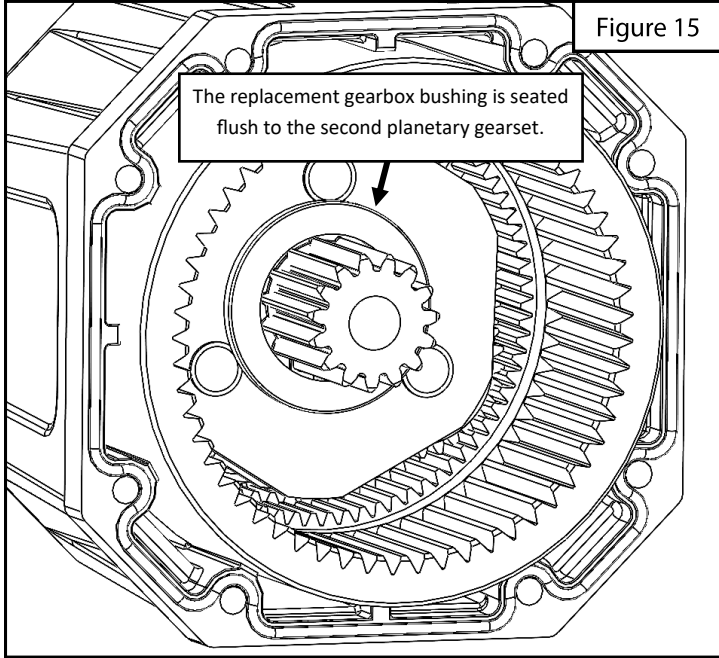

28. Reinstall the gearbox drum support. **Note:** Make sure that the replacement gearbox gasket is seated properly in the groove around the gearbox housing to ensure a proper seal.
29. Reinstall the drum and tie bar. See **Figure 17**. **Note:** Make sure to install the drum with the spline side to the gearbox as shown in the figure.

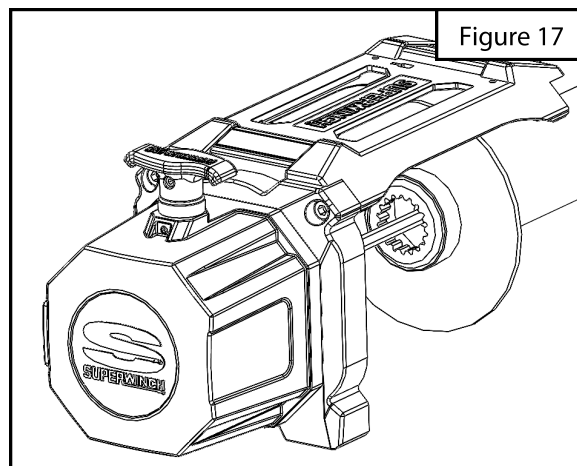

30. Reinstall the motor assembly to the tie bar. Refer back to **Figure 4**. **Note:** Make sure that the drum and driveshaft are seated before you tighten the two socket head bolts.
31. Open the remote control socket lid and remove the original socket seal by removing the phillips head screw securing it in place. See **Figure 19**.
32. Replace the socket seal (item 9) and reinstall the Phillips head screw that was previously removed.
33. Use the M8 serrated flange nuts removed in **step 4** to attach the motor cables to the motor terminals making sure to match the color of the motor terminal to the color of the motor cable.
34. Use the last M8 serrated flange nut removed in **step 4** to attach the control box ground cable and battery ground cable to the motor ground terminal.
35. Reconnect the power cable and ground cable from the battery.

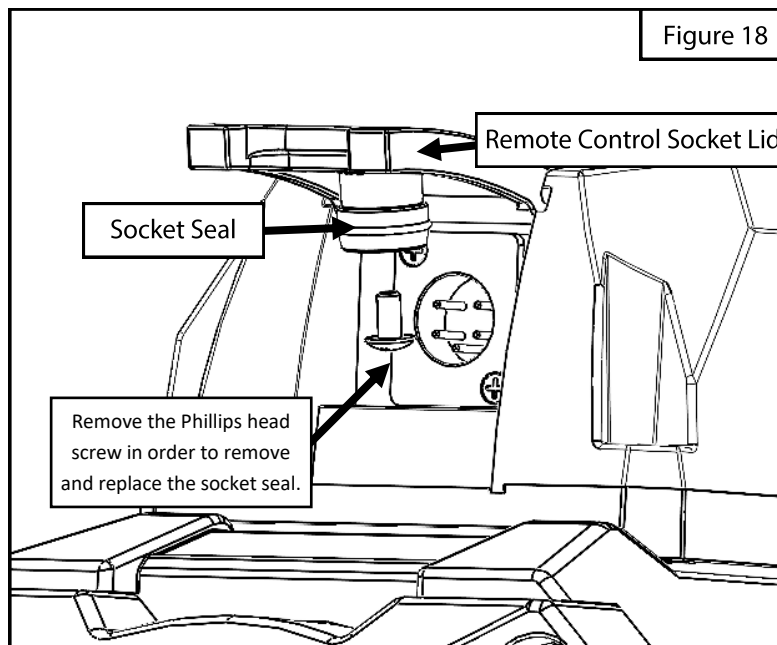

WARNING

Failure to follow these instructions could lead to death, personal injury, and / or property damage.

FASTENERS:

All SUPERWINCH supplied fasteners must be utilized and installed in accordance with the installation instructions and apply torque to the specifications as defined. DOUBLE CHECK ALL FASTENERS BEFORE INITIAL USE, AND PERIODICALLY IN THE FUTURE TO ENSURE PROPER FUNCTION AND SAFETY.

EYE PROTECTION:

ALWAYS WEAR SAFETY GLASSES OR GOGGLES DURING THE INSTALLATION PROCESS TO AVOID PERSONAL INJURY.

FOR CALIFORNIA RESIDENTS ONLY-PROP 65 WARNING:

Some products may contain chemicals such as DEHP, which can cause cancer, birth defects or other reproductive harm. For more info go to www.p65warnings.ca.gov



For more information on this and other products,
or to be put in contact with a Superwinch sales
rep or distributor, call (800) 323- 2031
or email info@superwinch.com

SUPERWINCH
320 W. COVINA BLVD.
SAN DIMAS, CA 91773

© 2019 SUPERWINCH®, Superwinch®, and S Superwinch® (design) are registered trademarks of Superwinch Inc. in the United States and/or other countries.